



**BURTONSAFES**  
THE SURE DEFENCE



# BURTON PULSE - DEAD BOLT LOCKING INSTRUCTIONS

# USER INSTRUCTIONS - BURTON PULSE

## ABOUT THE LOCK

This lock requires a 6-digit code to open the lock. You can have 2 different codes on this lock, the master code and the secondary code. This lock can also have a time delay activated of 1-99 minutes and an open period of 1-19 minutes.

### How to open the safe

- Enter a valid 6-digit code (the factory default is '123456')
- If the code has been entered correct the lock will beep twice
- Turn the keypad clockwise until it stops
- Turn the handle to the open position
- Open the safe door

### Incorrect Entry

- If an incorrect code has been entered, it will be followed by a long beep
- After 4 incorrect entries, a penalty time of 5 minutes will begin. During this time, no other code entries can be made
- When the penalty time is over enter a valid 6 digit code

NOTE: 2 more consecutive invalid codes will restart an additional 5 minutes penalty time

### How to close the safe

- Ensure that the bolts are fully retracted (if necessary rotate the handle clockwise to retract the bolts)
- Gently push the door shut. Always ensure that there are no objects or people in the way of the closing door
- Turn the handle bar anti-clockwise until the stop position is reached
- Turn the keypad to the upright position

### Activating the secondary code

(using the master code)

- Press and hold key [1] until the lock beeps twice
- Enter the 6-digit MASTER code
- Now enter a 6-digit code for the SECONDARY code; the lock will beep twice
- Enter the 6-digit code for the secondary code again to confirm. The lock will beep twice and the code is set

### Deleting the secondary code

(using the master code)

- Press and hold key [3] until the lock beeps twice
- Enter the 6-digit master code
- The secondary code is now deleted

### Changing your code

- Unlock and open the safe door
- Press and hold key [0] until the lock beeps twice
- Enter the current 6-digit code of the user you wish to change (master or secondary) the lock will beep twice
- Now enter the new 6-digit code, the lock will beep twice
- Enter the new 6-digit code again to confirm; the lock will beep twice.

NOTE: if there are any code entry errors, they will be followed by a long beep. The old code will remain valid and you can repeat the steps.

### Programming the time delay and open window

A time delay is the time you have to wait in between the entry of your code and the opening of your safe. An open window is the amount of time you have to open your safe. For example, if you wanted a 30 minute time delay and a 10 minute open window, this would mean that once you have entered a valid 6-digit code, you have to wait 30 minutes before you can open the safe door. After 30 minutes you will have 10 minutes to open the safe door. If you wait longer than 10 minutes, you have to start the process again.

- Press and hold key [9] until the lock beeps twice
- Enter the 6-digit master code
- Now enter the desired time delay and open window length, i.e. for a 30 minute time delay and 10 minute open window, enter: 3010
- The lock will beep twice
- Enter the time delay and open window again to confirm. The lock will beep twice.

## How to open the safe with the time delay active

- Enter a valid 6-digit code. If the code is entered correctly, the lock will beep twice
- When the time delay begins, the LED will flash every 2 seconds
- Once the time delay ends the open window will begin. During the open window, the lock will beep once every 2 seconds
- During this time, turn the handle to the open position and open the safe door

## How to change / remove the time delay active

- Enter a valid 6-digit code, if the code is entered correctly the lock will beep twice
- When the time delay begins the LED will flash every 2 seconds
- Once the time delay ends the open window will begin
- During the open window, follow the steps of programming the time delay to change time length
- To remove the delay, you need to enter 0001 for the time delay and open window

## Current supply / battery change

A series of beeps indicates that the battery is weak and must be replaced. Only use a 9V ALKALINE battery. (Burton Safes recommend the Duracell brand). The batteries are located in the bottom of the lock. Remove the battery cover and carefully take out the battery. Unclip the wire and replace the battery. Take care when changing batteries to ensure that no cables are damaged.

## How to turn on the light

Press the [OK] key and the LED will turn on.  
After 10 seconds the light will turn off automatically.

## FIXING GUIDE

When fixing your safe, it is important that it is fitted against a solid wall or concrete floor. Follow our guide below and for more information and guidance visit our website

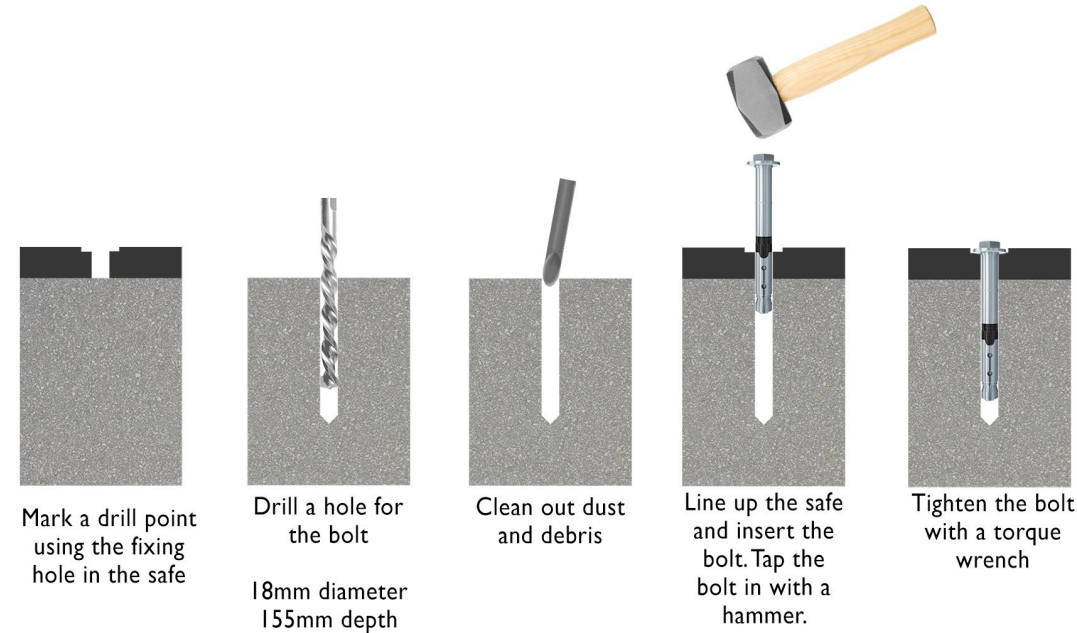

[www.burtonsafes.co.uk](http://www.burtonsafes.co.uk)



**BURTONSAFES**  
THE SURE DEFENCE®

## PRODUCT WARRANTY

Thank you for choosing Burton Safes.

Your new product carries a 2 year parts and labour warranty in respect of defects in materials and workmanship when registered on our website [www.burtonsafes.co.uk/warranty](http://www.burtonsafes.co.uk/warranty) or confirmed over the phone **+44 (0) 1484 663388**. Please also look out for the extended warranty and Safe for Longer stamps on the website or in our brochure.



5 Year extended warranty - At Burton Safes we are so confident in our products that we provide a 5 year extended warranty on all our Home Series safes for home consumers. Please register using the above details.



Safe for Longer - With all Safe for Longer stamped safes we provide a 5 year warranty and a **FREE REPLACEMENT\*** if your product is damaged during **BURGLARY** or **FIRE** for the life of the warranty Please register using the above details.

\*Ts & Cs apply, visit our website for full details.